

■ FEN Fixed Socket, Nut Fixing, With Earthing Tags

- Connector series: FEN
- Contact: Female
- Locking type: Self-locking
- Orientation type: Straight
- Part No.: FEN.00.250.CTL
- Mated with: PSA/PSC/PMS/PAS/PAV

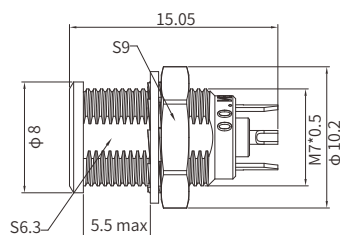

■ General Information

Ambient temperature:	-55°C ~ + 260°C
Endurance:	>5000 cycles
Insulator:	PTFE
Connector contacts:	Brass with gold plated
Housing:	Brass with Cr plated
Impedance:	50Ω
Operating Voltage:	0.7k V

Rated current:	4A
Insulator resistance:	≥100MΩ
VSWR:	1.09+0.11*f/GHz
IP rating:	IP 50
Shielding efficiency:	at 10MHz>75dB/at 1GHz>40dB
Salt spray corrosion test:	>144h

Part number	Weight(g)
FEN.00.250.CTL	2.5

PCB drilling pattern (page 171)

■ PSA Straight Plug With Cable Collet

- Connector series: PSA
- Contact: Male
- Locking type: Self-locking
- Orientation type: Straight
- Part No.: PSA.00.250.xTACxx
- Mated with: FAA/FAY/HWR/FAP/FEN

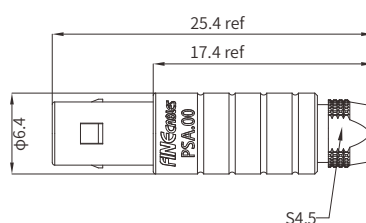

Note: "x" detail information see the table below

■ General Information

Ambient temperature:	-55°C ~ + 260°C
Endurance:	>5000 cycles
Insulator:	PTFE
Connector contacts:	Brass with gold plated
Housing:	Brass with Cr plated
Impedance:	50Ω
Operating Voltage:	0.7k V

Rated current:	4A
Insulator resistance:	≥100MΩ
VSWR:	1.09+0.11*f/GHz
IP rating:	IP 50
Shielding efficiency:	at 10MHz>75dB/at 1GHz>40dB
Salt spray corrosion test:	>144h

Part number	Cond. φmax	Dielectric φmax	Sheathφ	
			min	max
PSA.00.250.CTAC15	0.55	1.45	1.1	1.4
PSA.00.250.CTAC17	0.55	1.45	1.3	1.7
PSA.00.250.CTAC22	0.55	1.95	1.8	2.2
PSA.00.250.CTAC27	0.55	1.95	2.3	2.7
PSA.00.250.CTAC31	0.55	1.95	2.8	3.0